

Item	Qty	PART NUMBER	Description	STOCK NUMBER	Material	Length
1	1	CB-ACCU12235-W1	Lower clamp part	XPLAT30x3	DC01 C390	434 mm
2	1	CT-ACCU12235-W1	Upper clamp part	XPLAT30x3	DC01 C390	434 mm
3	1	K-ACCU12235-W1	Console part	XPLAT30x3	DC01 C390	446 mm
4	4	OAA-21017135M-01	Rivet Bushing Ø21	XPROPACCUW1	11SMnPb30 / 1.0718	
5	2	OBA-12800088M-00	DIN 933 - M12x80 Sk 8.8	XBOUTM12x80	Steel, Galvanized	
6	2	OMA-12000080M-00	DIN 934 - M12 Sk.8	XMOERM12	Steel, Galvanized	
7	1	RB-ACCU12235	Bottom rubber part	XRUBBER30x3	EPDM Shore 65°±5°	352 mm
8	1	RT-ACCU12235	Top rubber part	XRUBBER30x3	EPDM Shore 65°±5°	352 mm



© 2017 MPC INDUSTRIES BV, developed and designed by MPC INDUSTRIES BV

General Tolerances: according to: DIN 2768-vL

SURFACE TREATMENT AND OR PROTECTION:

Zinc plated

DIN50961: Fe/Zn 8-12µm

**Commercial
Drawing**

NOTICE TO PERSONS RECEIVING THIS DRAWING AND/OR TECHNICAL INFORMATION:
MPC Industries BV claims proprietary rights to the material disclosed hereon. This drawing and/or technical information is issued in confidence for engineering information only and may not be reproduced or used to manufacture anything shown or referred to hereon without direct written permission from MPC Industries BV to the user. This drawing and/or technical information is the property of MPC Industries BV and is loaned for mutual assistance to be returned when its purpose has been served.
THIS DRAWING AND/OR TECHNICAL INFORMATION IS THE PROPERTY OF MPC INDUSTRIES BV.
DO NOT SCALE FROM DRAWING.

Material: ACCU12235

Mass: 1,294 kg

Filename: ACCU12235.dwg

Sheet: 1 / 2

Third angle projection:

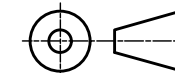

Part number:

ACCU12235

Drawn by: G. Kardos

Creation date: 18/11/2011

Checked by: M. Wiersma

Checked date: 21/11/2011

Scale 1 : 3

Units: mm

Status: Released

Description:

MPC Industries Accumulator clamp,
235-245mm, W1

Revision:

3

Format:

A3