

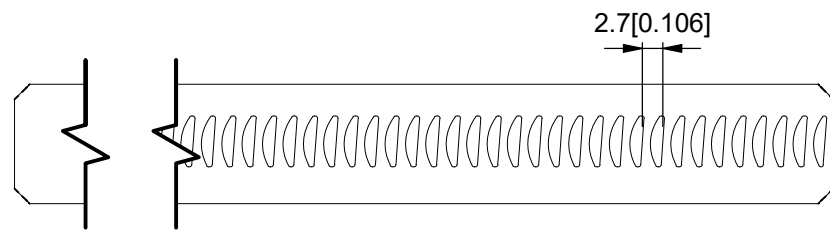

### Slotted area ( 1 : 1 )

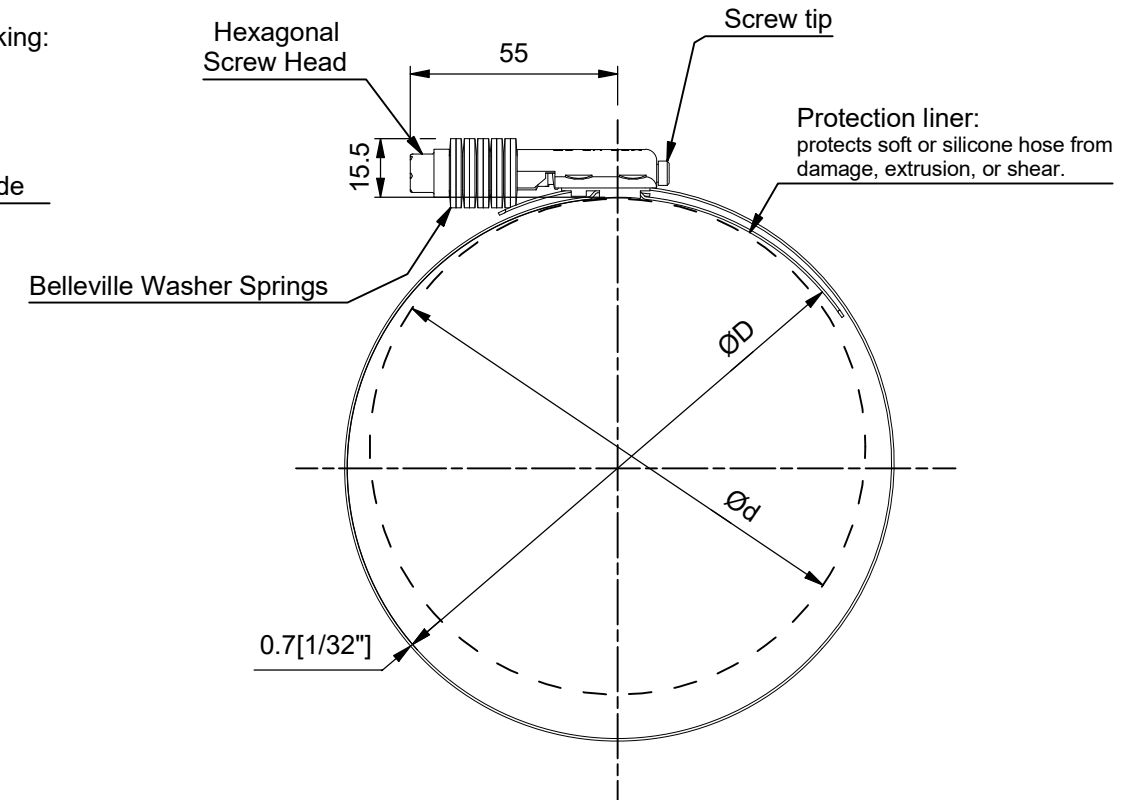

Rounding on the inside of the clamp to prevent incision in the hose

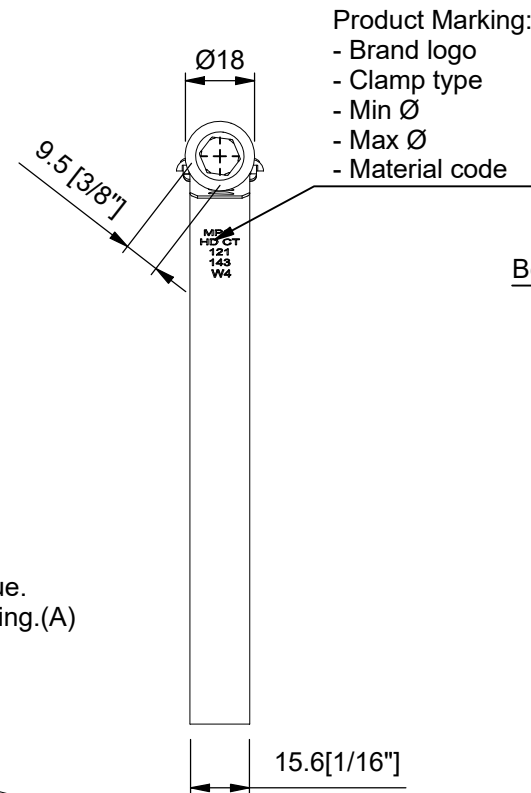
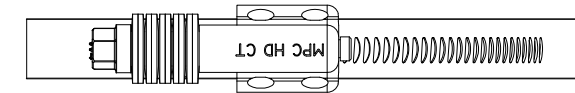

### Maximum Expansion

Clamps should be installed at  $\pm 5\text{Nm}$  of torque. Screw tip should slightly protrude from housing.(A)

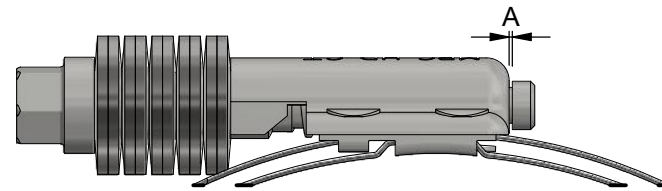

### Equal Expansion or Contraction

Clamps should be installed at  $\pm 10\text{Nm}$  of torque. Screw tip protrudes from housing (B) and Belleville springs are compressed half way.

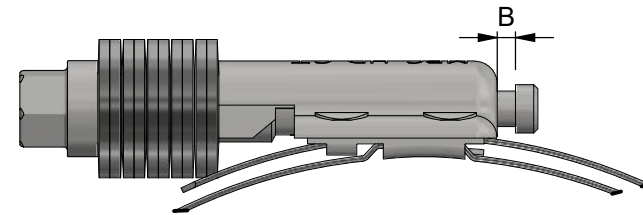

### Maximum Contraction

Clamps should be installed at  $\pm 14\text{Nm}$  of torque. Screw tip extends well beyond housing (C) and Belleville springs are compressed to about 90%.

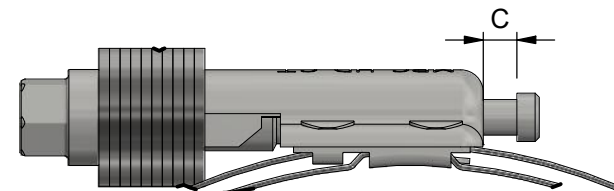

MPC HD Constant Torque Clamps sizes					
SAE SIZE	Effective Clamping range				MPC Industries P/N:
	dØ		ØD		
	mm	Inch	mm	Inch	
212	32	1 ¼	54	2 1/8	HDCT4032
262	45	1 ¾	67	2 5/8	HDCT4045
312	57	2 ¼	79	3 1/8	HDCT4057
362	70	2 ¾	92	3 5/8	HDCT4070
412	83	3 ¼	105	4 1/8	HDCT4083
462	95	3 ¾	118	4 5/8	HDCT4095
512	108	4 ¼	130	5 1/8	HDCT4108
562	121	4 ¾	143	5 5/8	HDCT4121
612	133	5 ¼	156	6 1/8	HDCT4133
662	146	5 ¾	168	6 5/8	HDCT4146
712	159	6 ¼	181	7 1/8	HDCT4159
762	172	6 ¾	194	7 5/8	HDCT4172
812	184	7 ¼	206	8 1/8	HDCT4184
862	197	7 ¾	219	8 5/8	HDCT4197
912	210	8 ¼	232	9 1/8	HDCT4210

Rev.	Date	Description	DESIGNER
B	13-2-2019	Added material W2 (aisi 430+carbon steel zn plated screw) and W5 (aisi 316) to this sheet	M. Wiersma
A	18/07/2018	Drawing renewed	C.P. Dijkstra

		© 2017 MPC INDUSTRIES BV, developed and designed by MPC INDUSTRIES BV	
General Tolerances: according to: DIN 2768-vL		<h1>Datasheet</h1>	
SURFACE TREATMENT AND OR PROTECTION:			
Material: W2, W4 and W5		Mass: N/A	
Filename: HDCT.dwg		Sheet: 1 / 1	
NOTICE TO PERSONS RECEIVING THIS DRAWING AND/OR TECHNICAL INFORMATION: MPC Industries BV claims proprietary rights to the material disclosed hereon. This drawing and/or technical information is issued in confidence for engineering information only and may not be reproduced or used to manufacture anything shown or referred to hereon without direct written permission from MPC Industries BV to the user. This drawing and/or technical information is the property of MPC Industries BV and is loaned for mutual assistance to be returned when its purpose has been served. THIS DRAWING AND/OR TECHNICAL INFORMATION IS THE PROPERTY OF MPC INDUSTRIES BV DO NOT SCALE FROM DRAWING.		Part number: <h1>HD-CT</h1>	
Drawn by: Gy.Kardos	Creation date: 23-5-2017	Description: Technical data MPC HD-CT Clamp. Available in W2 (aisi 430 with steel Zn plated screw) W4 (all AISI 304) and W5 (All AISI 316)	
Checked by: M. Wiersma	Checked date: 28-5-2017		
Scale 1 : 2	Units: mm [inch]	Revision: <h1>B</h1> Format: <h1>A3</h1>	
Status: Released			