

Parts identification (1 : 4)

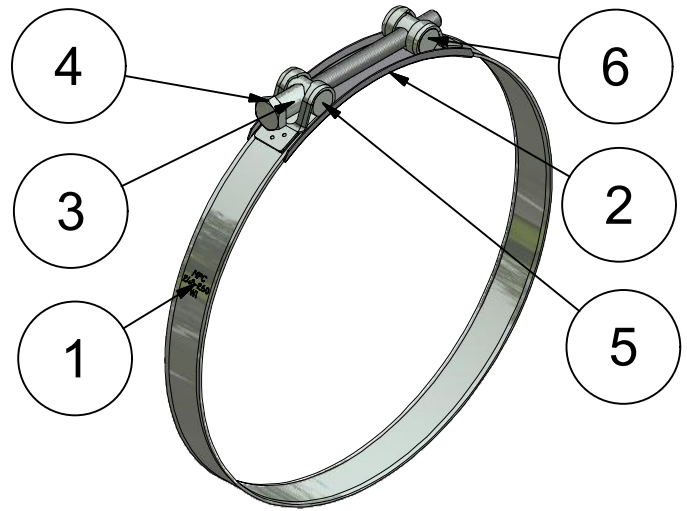

Item	Qty	Description	Material
1	1	Clamp part	Zinc plated, Steel, Mild
2	1	Bridge part	Zinc plated, Steel, Mild
3	1	Spacer	Zinc plated, Steel, Mild
4	1	Hex-Head Bolt M10x120	Zinc plated, St 8.8
5	1	Trunnion	Zinc plated, Steel, Mild
6	1	Trunnion	Zinc plated, Steel, Mild

Front view (1 : 4)

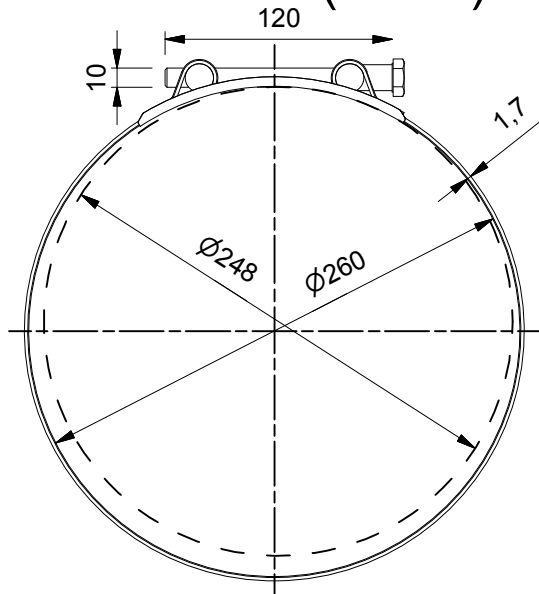

Side view (1 : 4)

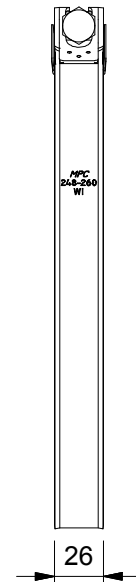

© 2013 MPC INDUSTRIES BV, developed and designed by MPC INDUSTRIES BV

General Tolerances: according to: DIN 2768-VL

SURFACE TREATMENT AND OR PROTECTION:

NOTICE TO PERSONS RECEIVING THIS DRAWING AND/OR TECHNICAL INFORMATION:

MPC Industries BV claims proprietary rights to the material disclosed herein. This drawing and/or technical information is issued in confidence for engineering information only and may not be reproduced or used to manufacture anything shown or referred to hereon without direct written permission from MPC Industries BV to the user. This drawing and/or technical information is the property of MPC Industries BV and is loaned for mutual assistance to be returned when its purpose has been served.
THIS DRAWING AND/OR TECHNICAL INFORMATION IS THE PROPERTY OF MPC INDUSTRIES BV

DO NOT SCALE FROM DRAWING.

Material:

Dimensions:

Doc no.: S248.dwg

Third angle projection:

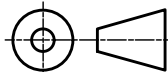

Part number:

S248

Description:

MPC Industries S clamp 248-260 mm, W1

Revision:

Format:

A4

Drawn by: Gyula

Creation date: 4-4-2014

Checked by:

Checked date:

Scale 1:4

Units: mm

Status: Released